

LANGLEY SINK CABINET (60 cm) TWO

You Can Install According To The Specified Numbers.

ASSEMBLY GUIDE

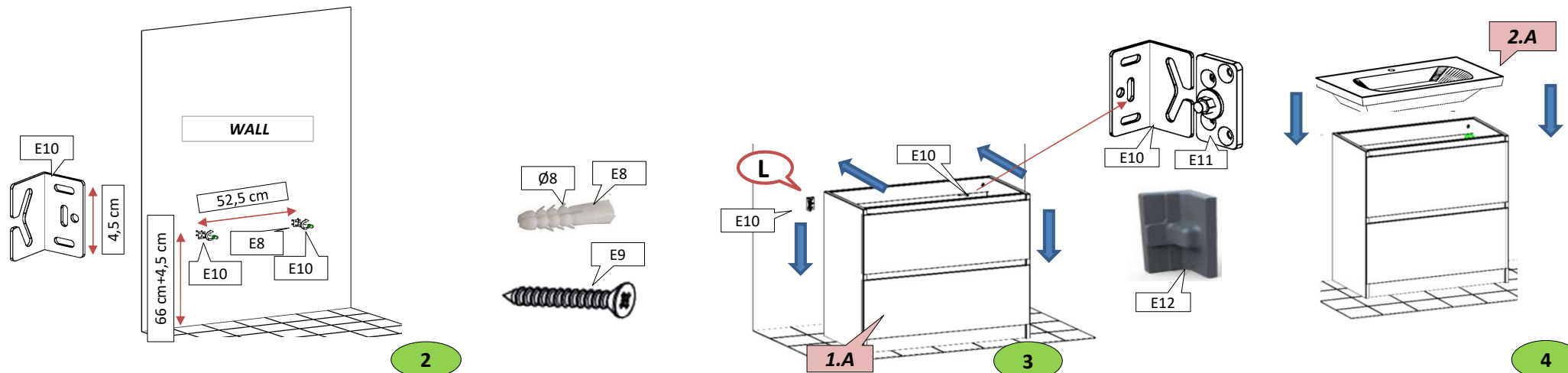
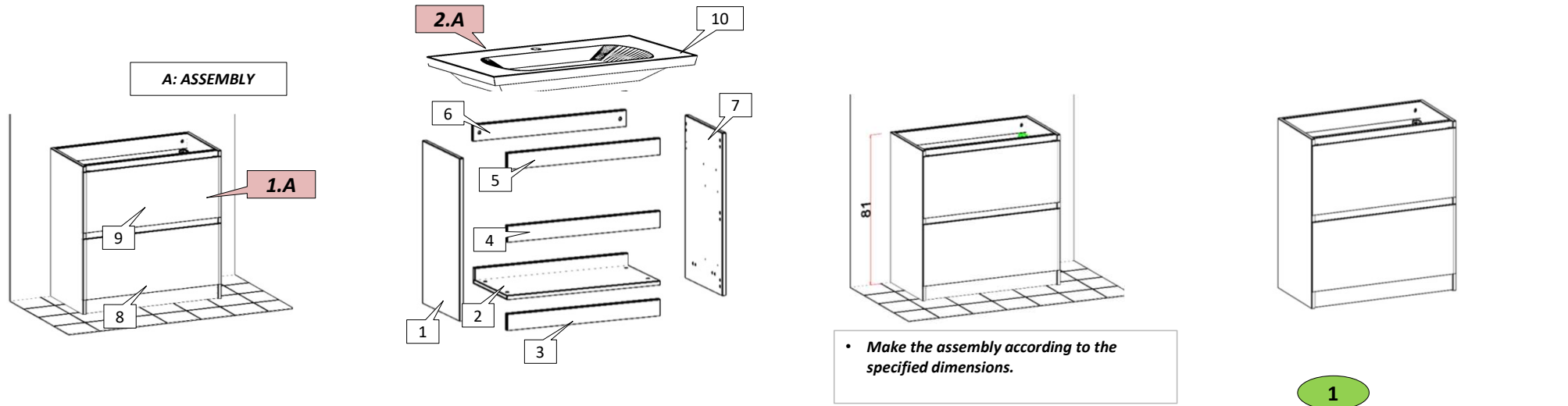

E1X1	E2X1	E3X1	E4X1	E5X1	E6X1	E7X1	E8X4	E9X4	E10X2	E11X2	E12X2		

If you need a spare part, please provide the "model number and part number" shown in the installation instructions.